

pewag lifting jacks

Rack & pinion jack systems





Developed & manufactured in Europe since 1869

Product Range and Innovations

The company offers a diverse range of lifting equipment, focusing on quality and customization.

- Extensive product line includes DIN-standard steel winches, rack gears, and specialized lifting jacks.
- Products can be customized based on customer specifications and drawings.
- Innovations include improved gear components and quality management systems to enhance performance.

Quality Assurance and Standards

All lifting devices are rigorously tested to ensure safety and compliance with industry standards.

- Products are tested according to BGV D8 before delivery.
- Internal quality management ensures high standards and reduced tolerances in gear components.
- Use of optimal materials and improved heat treatment processes to minimize wear.

Technical Specifications of Key Products

Detailed specifications are provided for various lifting devices, highlighting their capabilities and features.

All jacks are available with lifting capacities from 1,5 tons - 10 tons and are available with safety crank or safety crank with ratcheted function

Customization and Special Orders

The company accommodates special requests for customized lifting solutions.

- Offers tailored lifting heights and rack lengths upon request.
- Special designs can be developed to meet specific operational needs.
- Flexibility in production allows for unique configurations based on client requirements.

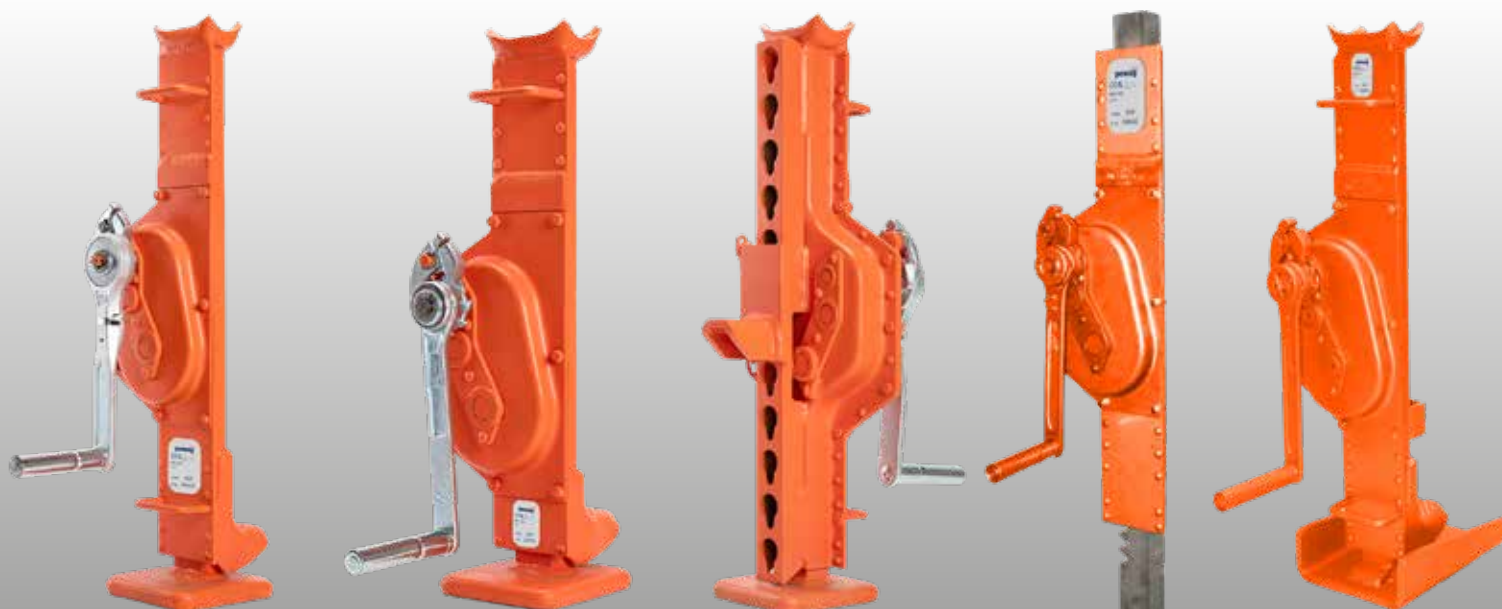

Content

A variety of rack & pinion Jack systems for use in:

- Mining
- Welding
- Steel Construction
- Industrial Repair Stations
- Heavy-duty Repair Shops
- Railroad Construction
- Cable Construction
- Roofing, Wall Building & Carpentry
- Woodwork

Product Range

Rack & pinion	4-5
Gerabox	6-7
Rail mod	6-7
Cable drum	6-7
Automotive	8
Wall mounts	8
Sluice gate	9
Custom	10
Spare parts	11-16

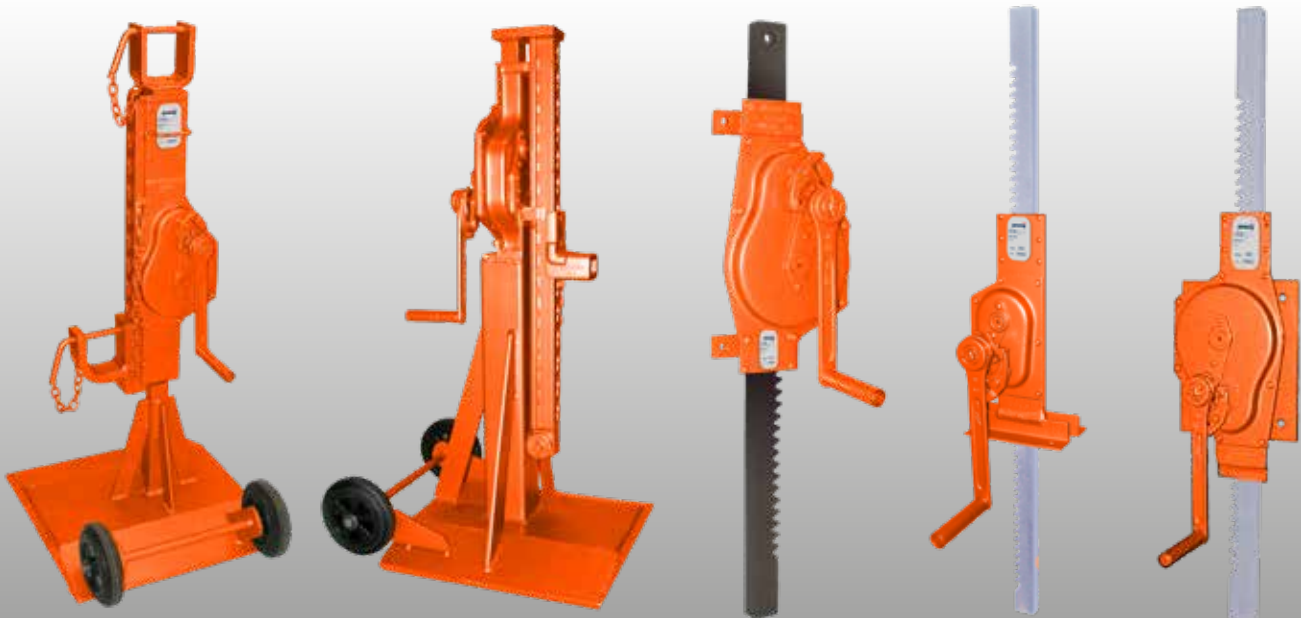

pewag^{red} Rack Jack DIN 7355

The DIN Rack jack no. 10 is a tool that can be used with great variability and has become famous in industry and in the workshop through its simple and effective design.

The DIN rack jack is used for lifting, lowering, holding and bracing loads of 1.5 t to 10 t in all conceivable positions.

By optimising the gear components, we have managed to perfect the process, easing work and reducing wear.

Tech. data and main dimensions	No. 10 DIN rack jack according to DIN 7355			
	1,5 t	3 t	5 t	10 t
Lifting force on head and claw	1,5 t	3 t	5 t	10 t
Installation height	725 mm	725 mm	725 mm	725 mm
Lifting height	350 mm	350 mm	300 mm	300 mm
Height of claw in lowest position	70 mm	75 mm	70 mm	90 mm
Weight	12 kg	20 kg	24 kg	42 kg
Catalogue number with				
Safety crank	4134384	4134385	4134386	4134387
Safety crank ratched function	4134388	4134389	4134390	4134391



pewag^{red} Rack Jacks according DIN 7355, Shortened Design

The rack jacks made according to DIN 7355 in shortened design are especially suitable for lifting and lowering loads with low insertion heights.

Despite low insertion heights, the piston travel was basically maintained without changing the load capacity. The weight was reduced, making handling easier.

Tech. data and main dimensions	No. 12 rack jacks according to DIN 7355, shortened			
	1,5 t	3 t	5 t	10 t
Lifting force on head and claw	1,5 t	3 t	5 t	10 t
Installation height	570 mm	570 mm	600 mm	650 mm
Lifting height	300 mm	300 mm	300 mm	300 mm
Height of claw in lowest position	70 mm	75 mm	70 mm	80 mm
Weight	11 kg	18 kg	22 kg	38 kg
Catalogue number with				
Safety crank	4134392	4134393	4134394	4134395
Safety crank ratched function	4134396	4134397	4134398	4134399



pewag Rack Jacks According To DIN 7355, Adjustable Claw

Our adjustment rail facilitates quickly hanging the claw across the entire length of the rack jack. That means it can be latched in immediately at the height of the load to be lifted and the stroke is completely utilised.

Tech. data and main dimensions	No. 18 Rack jack according to DIN 7355, adjustable claw			
Lifting force on head and claw	1,5 t	3 t	5 t	10 t
Installation height	725 mm	725 mm	725 mm	725 mm
Lifting height	350 mm	350 mm	300 mm	300 mm
Height of claw in lowest position	80 mm	80 mm	80 mm	80 mm
Weight	17 kg	23 kg	29 kg	46 kg
Catalogue number with				
Safety crank	4134458	4134459	4134460	4134461
Safety crank ratched function	4134464	4134465	4134463	4134462



Main dimension	No. 18 Adjustable claw			
Lifting force	1,5 t	3 t	5 t	10 t
H3	725 mm	725 mm	725 mm	800 mm
Stroke	350 mm	350 mm	300 mm	300 mm
H1	80 mm	80 mm	80 mm	80 mm
H2	430 mm	430 mm	380 mm	380 mm
H4	95 mm	95 mm	100 mm	105 mm
H5	525 mm	525 mm	525 mm	590 mm
VH	55 mm	55 mm	55 mm	55 mm
B1	125 mm	204 mm	189 mm	250 mm
B2	78 mm	92 mm	100 mm	132 mm
B3	90 mm	100 mm	110 mm	140 mm
B4	130 mm	130 mm	140 mm	140 mm
B5	140 mm	140 mm	160 mm	160 mm
B6	70 mm	70 mm	70 mm	80 mm
B7	71,5 mm	77,5 mm	88,5 mm	104 mm
B8	157 mm	163 mm	174 mm	204 mm
B9				
M	35 mm	45 mm	50 mm	60 mm
N	25 mm	30 mm	40 mm	50 mm
VK	14 mm	14 mm	14 mm	17 mm

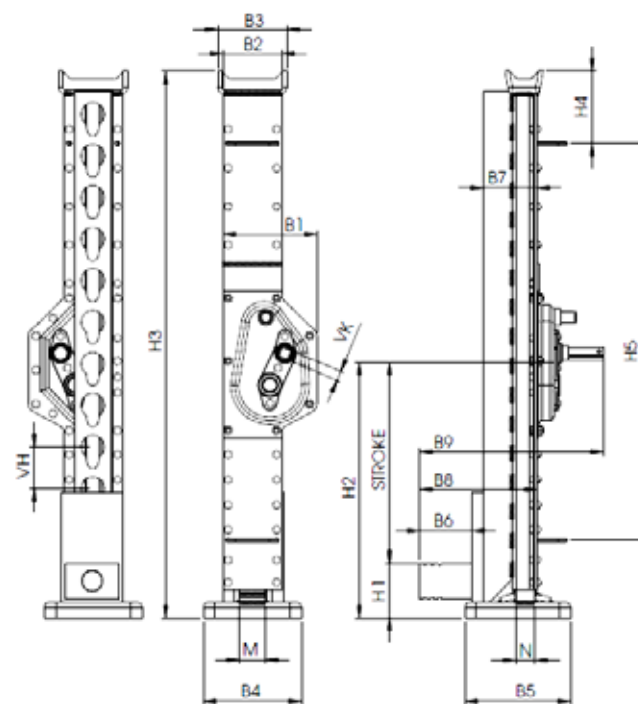

pewag^{red} Universal Rack

Universal rack and pinion gearbox, unpainted to pull or push, depending on the installation direction, for carrying load safe between 300mm and 350mm.

Customized stroke is possible from 100 to 3000mm, it is also possible to design the body to your application

Tech. data and main dimensions	No. 13 rack and pinion gearbox, unpainted			
	1,5 t	3 t	5 t	10 t
Lifting force	1,5 t	3 t	5 t	10 t
Installation height	675 mm	675 mm	675 mm	675 mm
Lifting height	350 mm	350 mm	300 mm	300 mm
Weight	12 kg	20 kg	24 kg	42 kg
Catalogue number with				
Safety crank	4134457	4134456	4134455	4134454
Safety crank ratchet function	4134453	4134452	4134451	4134425



pewag^{red} Track Lifting Jack according to DIN 7355

The track lifting jack in accordance with DIN 7355 was developed for lifting tracks. The specially formed track winch shoe and the track supports welded to the housing indicate the use of the device in track construction laying.

The flat track winch shoe on the bottom, provided with rounded off edges, also turns this product into the ideal helper during formwork construction.

Tech. data and main dimensions	No. 14 Track lifting jack according to DIN 7355		
	3 t	5 t	10 t
Lifting force on head and claw	3 t	5 t	10 t
Installation height	715 mm	715 mm	790 mm
Lifting height	350 mm	300 mm	300 mm
Height of claw in lowest position	65 mm	65 mm	80 mm
Weight	23 kg	26 kg	44 kg
Catalogue number with			
Safety crank	4134383	4134401	4134402
Safety crank ratched function	4135884	4135885	4135886



pewag Cable Drum Winch according to DIN 7355

We developed the cable drum winches for lifting cable drums according to DIN 7355.

The 1.5 t cable drum winches have three welded claws to mount the cable drums. The 3 t - 10 t cable drum winches have a rotating horn with a safeguard and an adjustable lateral hook connector with a safeguard.

The cable drum winches from our production are constructed especially robust, with consequential longevity and low wear.

Tech. data and main dimensions	No. 19 Cable drum winches according to DIN 7355			
	1,5 t	3 t	5 t	10 t
Lifting force on head and claw	1,5 t	3 t	5 t	10 t
Installation height	740 mm	1000 mm	1300 mm	1300 mm
Lifting height	265 mm	305 mm	330 mm	310 mm
Bearing height of the head claw	650 mm			
Bearing height of the centre claw	425 mm			
Bearing height of the lower claw	200 mm			
Suitable for cable drums from		700 mm	930 mm	1160 mm
Suitable for cable drums fto		2600 mm	3000 mm	3000 mm
Weight	30 kg	64 kg	70 kg	88 kg
Catalogue number with				
Safety crank	4134403	4134404	4134405	4134406
Safety crank ratched function	4134407	4134408	4134409	4134410



pewag[®] Body Winch according to DIN 7355

The DIN Rack jack no. 10 is a tool that can be used with great variability and has become famous in industry and in the workshop through its simple and effective design.

The DIN rack jack is used for lifting, lowering, holding and bracing loads of 1.5 t to 10 t in all conceivable positions.

By optimising the gear components, we have managed to perfect the process, easing work and reducing wear.

Tech. data and main dimensions	Body winch according to DIN 7355	
Lifting force on head	5 t	8 t
Lifting force on claw	5 t	8 t
Installation height	1100 mm	1100 mm
Lifting height	500 mm	500 mm
Height of claw in lowest position		
Weight	80 kg	118 kg
No. 24 with safety crank	4134315	4134314
No. 24a with safety crank ratched function	4134313	4134312



pewag[®] Wall Rack and Pinion Jack according to DIN 7355

The rack and pinion jacks according to DIN 7355 are designed for wall mounting. The mounting tabs are dimensioned so that the winch can be screwed to the wall.

This lifting equipment is suitable for lifting covers in greenhouse construction and container construction.

Naturally we can also offer **5 t - 10 t rack and pinion jacks on request!**

Other rack and pinion lengths and mounting clearances can be manufactured on request!

Tech. data and main dimensions	No. 26 Rack and pinion jacks according to DIN 7355	
Lifting force	1,5 t	3 t
Rack and pinion cross section	35 x 25 mm	45 x 30 mm
Lifting height	500 mm / 700 mm / 900 mm	500 mm / 700 mm / 900 mm
Stroke per crank rotation	14 mm	8 mm
Drill hole mount	23 kg	26 kg
Mounting tabs	13 mm	13 mm
Mounting tab hole clearances	100 x 225 mm	110 x 330 mm
Distance wall to front edge of crank handle	140 mm	160 mm
Cranking force to be applied	25 kg	25 kg
Weight	12 kg	21 kg
Catalogue number with		
Safety crank	4134378 4134379 4134380	4134381 4134382 4134361
Safety crank ratched function	4134360 4134359 4134358	4134357 4134342 4134316



pewag[®] Sluice Gate Jack according to DIN 7355

The sluice gate jacks according to DIN 7355 were developed as sluice system lifting elements. They can be fastened with either structural angles or with back metal sheets.

No. 22 Sluice gate jacks with mounting brackets according to DIN 7355				
Tech. data and main dimensions	1,5 t	3 t	5 t	10 t
Traction	1,5 t	3 t	5 t	10 t
Rack and pinion length	1150 mm	1260 mm	1280 mm	1405 mm
Lifting height	800 mm	800 mm	800 mm	800 mm
Mounting hole bore gauge				
Mounting bracket	130 x 70 mm	130 x 80 mm	200 x 100mm	280 x 120mm
Weight	14 kg	24 kg	32 kg	53 kg
Catalogue number with				
Safety crank	4134411	4134412	4134413	4134414
Safety crank ratched function	4134415	4134416	4134417	4134419

No. 23 Sluice gate jacks with back metal sheets according to DIN 7355				
Tech. data and main dimensions	1,5 t	3 t	5 t	10 t
Traction	1,5 t	3 t	5 t	10 t
Rack and pinion length	1150 mm	1260 mm	1280 mm	1405 mm
Lifting height	800 mm	800 mm	800 mm	800 mm
Mounting hole bore gauge				
Back metal sheets	130 x 160 mm	165 x 220 mm	180 x 250 mm	220 x 310 mm
Weight	14 kg	24 kg	32 kg	53 kg
Catalogue number with				
Safety crank	4134420	4134421	4134422	4134423
Safety crank ratched function	4134424	4134400	4134376	4134377



We would also be glad to manufacture other stroke and pinon-gear rack lengths based on your requirements.

pewag Custom Jack Systems

pewag Jacks can be designed and manufactured to the highest quality for all your requirements.

For more information, please contact the pewag customer service team.



pewag Spare parts

We offer spare parts for all our products.

Type	Capacity	Item No.
gear body	1,5 t	4134626
gear body	3 t	4134625
gear body	5 t	4134156
gear body	10 t	4134649
gear body, cover	1,5 t	4134673
gear body, cover	3 t	4134672
gear body, cover	5 t	4134155
gear body, cover	10 t	4134671
rack with base according to DIN7355	1,5 t	4134448
rack with base according to DIN7355	3 t	4134447
rack with base according to DIN7355	5 t	4134446
rack with base according to DIN7355	10 t	4134632
rack with base according to DIN7355 shortened design	1,5 t	4134666
rack with base according to DIN7355 shortened design	3 t	4134665
rack with base according to DIN7355 shortened design	5 t	4134057
rack with base according to DIN7355 shortened design	10 t	4134053
rack with base according to DIN7355 adjustable design	1,5 t	4134664
rack with base according to DIN7355 adjustable design	3 t	4134663
rack with base according to DIN7355 adjustable design	5 t	4134662
rack with base according to DIN7355 adjustable design	10 t	4134661
rack with base for railroad according to DIN7355	3 t	4134631
rack with base for railroad according to DIN7355	5 t	4134630
rack with base for railroad according to DIN7355	10 t	4134055
rackbase for railroad single	3 t - 10 t	4134657
claw	1,5 t	4134640
claw	3 t	4134639
claw	5 t	4134638
claw	10 t	4134637
head	1,5 t	4134656
head	3 t	4134655
head	5 t	4134654
head	10 t	4134635

We offer spare parts for all our products.

Type	Capacity	Item No.
bearing front	1,5 t	4134634
bearing back	1,5 t	4134614
bearing front/back	3 t	4134633
bearing front	5 t	4134616
bearing back	5 t	4134652
bearing front	10 t	4134615
bearing back	10 t	4134612
adjustable claw No.18	1,5 t	4134583
rack drive	1,5 t	4134651
rack drive	3 t	4134574
rack drive	5 t	4134500
rack drive	10 t	4134501
middle drive	5 t	4134505
middle drive	10 t	4134345
crank drive	1,5 t	4134506
crank drive	3 t	4134507
crank drive	5 t	4134508
crank drive	10 t	4134509
crank drive perpetrated design	1,5 t	4134353
crank drive perpetrated design	3 t	4134354
crank drive perpetrated design	5 t	4134355
crank drive perpetrated design	10 t	4135935
gear to rack drive	1,5 t	4134514
gear to rack drive	3 t	4134648
gear to rack drive	5 t	4134647
gear to rack drive	10 t	4134646
gear to middle drive	5 t	4134645
gear to middle drive	10 t	4134644

pewag Spare parts

We offer spare parts for all our products.

Type	Capacity	Item No.
EZW 64.0502 basic 400V 50Hz END20.20		4135643
EZW 64.0504 basic 400V 50Hz END20.20		4135644
EZZ 64.0510 rack 1000H 1300mm		4135645
EZW 64.2002 basic 400V END20.20		4135646
EZZ 64.2010 rack 1000H 1300mm		4135647
EZZ 64.9810 rack cover 1100mm		4135648
EZZ 64.9820 rack cover 5000N 1000/1200H		4135649
BKS 45.0634 We06->pipe 1" incl. Screws		4135650
BKS 45.6634 cluchs		4135651
TST 21.1001 taster 230V up/down		4135652
HZW 45.0110 ZWmK ohne Zst. I6-Kant		4135653
HZW 45.0111 ZWoK ohne Zst. I6-Kant		4135654
HZZ 45 rack 0200H 0350mm		4135655
HZZ 45 rack 0400H 0550mm		4135656
HZZ 45 rack 0600H 0750mm		4135657
HZZ 45 rack 0800H 0950mm		4135658
HZZ 45 rack 1000H 1150mm		4135659
HZZ 45.0198 rack stop		4135660
HZW 53.0301 Getriebe 3000N		4135661
HZW 53.0310 ZWmK ohne Zahnst. We04 3000N		4135662
HZW 53.0311 ZWoK ohne Zahnst. We04 3000N		4135663
HZZ 53 rack 0400H 0600mm 3000N		4135664
HZZ 53 rack 0600H 0800mm 3000N		4135665
HZZ 53 rack 0800H 1000mm 3000N		4135666
HZZ 53 rack1000H 1200mm 3000N		4135667
HZZ 53 rack1200H 1400mm 3000N		4135668
HZZ 53 rack 1400H 1600mm 3000N		4135669
HZZ 53.0398 rack stop		4135670
HZW 53.0601 Getriebe ohne Zahnst.		4135671
HZW 53.0610 ZWmK ohne Zahnst. We04 6000N		4135642
HZW 53.0611 ZWoK ohne Zahnst. We04		4135672
HZW 53.0622 Ard 0000 mm stroke An-We04		4135673
HZW 53.0626 Ard ohne Zahnst. An-We61		4135674
HZZ 53 rack 0400H 0600mm 6000N		4135675
HZZ 53 rack 0600H 0800mm 6000N		4135676
HZZ 53 rack 0800H 1000mm 6000N		4135677
HZZ 53 rack 1000H 1200mm 6000N		4135678
HZZ 53 rack 1200H 1400mm 6000N		4135679
HZZ 53 rack 1400H 1600mm 6000N		4135680
HZZ 53 rack 1600H 1800mm 6000N		4135681
HZZ 53.0698 rack stop		4135682

We offer spare parts for all our products.

Type	Capacity	Item No.
HZW 55.1201 Standard ohne Zahnst.		4135683
HZW 55.1210 ZWmK ohne Zahnst.		4135684
HZW 55.1211 ZWoK ohne Zahnst.		4135685
HZW 55.1212 ZWAvK ohne Zahnst.		4135686
HZW 55.1213 ZWArd ohne Zahnst.		4135687
HZW 55.1220 AvK ohne Zahnst.		4135688
HZW 55.1221 Avb ohne Zahnst.		4135689
HZW 55.1222 Ard ohne Zahnst.		4135690
HZZ 55 rack 0600H 0800mm		4135691
HZZ 55 rack 0800H 1000mm		4135692
HZZ 55 rack 1000H 1200mm		4135693
HZZ 55 rack 1200H 1400mm		4135694
HZZ 55 rack 1400H 1600mm		4135695
HZZ 55 rack 1600H 1800mm		4135696
HZZ 55.1298 rack stop		4135697
VRE 30.0202 Schneckengetriebe 200 Nm		4135698
VRE 75.1550 Schneckengetriebe 150 Nm		4135699
HKU 01.2001 Handkurbel HKU 01, KI=200		4135700
HKU 01.2010 Kurbel KI=200 -> We61 + 100verl.		4135701
HKU 01.2020 Kurbel 200 ¾"Rohr Ø20+M8		4135702

Type	Capacity	Item No.
double latch incl. spring		4134579
safety crank head 1,5-5t 17mm drive square		4134597
drive deployment 35x35mm Vkt 14mm		4134596
drive deployment 35x35mm Vkt 17mm		4134595
drive deployment 35x50mm Vkt 14mm		4134594
drive deployment 35x50mm Vkt 17mm		4134593
safety crank MS KLG vz.		4134592
safety crank Vkt 14/3 KU KLG vz		4134643
safety crankl 1,5t		4135575
safety crank Vkt 14/3 MS schwarz		4134641
safety crank Vkt 17/1,5 MS KLG vz		4135578
safety crank Vkt 17/1,5 KU KLG vz		4134642
safety crank Vkt 14/3 MS KLG Sonder gebogen vz		4134104
safety crank Vkt 14/3 KU KLG Sonder gebogen vz (standard)		4134496
safety crank Vkt 14/3 KU KLG Sonder gebogen vz (custom)		4134103
safety crank ratchet function 10 t MS KLG vz.		4134591
safety crank ratchet function 1,5 t - 5 t KU KLG vz.		4134590
safety crank ratchet function 1,5 t		4134589

pewag Spare parts

We offer spare parts for all our products.

Type	Capacity	Item No.
handle SIKU / RAKU 1,5 t - 5 t KLG130 13,9x7mm to weld		4134588
safety crank ratchet function RSK070 Vkt 17/3 KU KLG vz		4134587
safety crank ratchet function Vkt 14/3 MS KLG vz		4134586
`Druckrollen -` safety crank head 1,5-5t Vkt 14/3 inside drive square		4134585
`Druckrollen -` safety crank 1,5-5 t Vkt 14/3 KLG130 vz		4134584
`Druckrollen -` safety crank Vkt 14/3 KLG130 mit 12er Bohrung ca. 10-15mm en		4134043



pewag austria GmbH

A-8041 Graz, Gaslaternenweg 4, Phone: +43 316 6070-0, Fax: +43 316 6070-100,
saleinfo@pewag.com, www.pewag.com

